

Specification Grade Floodlight

Building Wallwash

Landscape Accent

Facade Lighting



FL-220-LSM



FL-320-LSM

FOCCA

Specifications



- Certifications** The fixture shall be ETL and CETL listed for wet location. Also meets IP65 standard.
- Lamp Housing** Die-cast aluminum mounted to die-cast yoke bracket with stainless steel fasteners. Supplied with two quadrants marked 0° to 90° for accurate field vertical tilt adjustment. Horizontal field adjustment to 360°.
- Lens Assembly** Die cast aluminum attached to lamp housing with stainless steel roll pin. Die cast aluminum latches allow for tool-less entry into the lamp housing. Clear flat tempered glass standard.
- Ballast Housing** Extruded aluminum with die cast end caps. (EBH) Ballast mounted on removable tray for ease of access. Front end cap has die cast aluminum bracket for mounting to cross-arm or wall mount. Modular design allows for remote ballast option.. Cast aluminum surface mount housing also available. (LSM and SSM)
- Lamp Holder** Porcelain medium (150W and below) and mogul (200W and above) base for HID lamp source. Porcelain G12 supplied when T6 lamp specified.
- Reflectors** Spun aluminum silver-anodized with three beam spreads (N) narrow, (M) medium and (W) wide. Field adjustable option (ADJ) allows for spot to flood adjustment. Other optical packages available, consult factory.
- Options** The following options are available: field installable die cast visor (V) which mounts to lens assembly with stainless steel hardware; color filters (CF) available in red, blue, green and yellow; concentric ring louver (RL) and cross louver (CLV) available.
- Finish** BK-BZ-WH-GR-GY-NA baked enamel standard, other colors available.

PROJECT
FIXTURE TYPE
CATALOG#

FL-220/320

 Some luminaires use fluorescent or high intensity discharge (HID) lamps that contain small amounts of mercury. Such lamps are labeled "Contains Mercury" and/or with the symbol "Hg." Lamps that contain mercury must be disposed of in accordance with local requirements. Information regarding lamp recycling and disposal can be found at www.lamprecycle.org

Product Order Guide

Series	Max Watts	Lamp Type	Voltage ¹	Finish ⁶	Options
FL-220	150MH	E17	120	BK Black	V Visor
	150MH	T-6	208	BZ Bronze	CL Color Lens (specify Color)
	150HPS	E17	240	WH White	NO Narrow Optics
			277	GR Green	MO ² Medium Optics
FL-320	320MHP	ED-28 ⁷		NA Natural Alum.	WO ² Wide Optics
	250HPS	ED-28 ⁷		GY Gray	SL1 ³ 5Hx3V rectangular beam
	400HPS	ED-18		CC Custom Color	SL2 ³ 5Hx4V rectangular beam
					MO1 ³ 3Hx3V medium beam
				MO2 ³ 4Hx4V medium beam	
					RL ³ Ring Louver
					CLV Cross Louver
					WMS ^{2,4} Wall Mount Surface
					WMR ² Wall Mount Recessed
					LSM Large Surface Mount
					SSM Small Surface Mount
					ADJ ⁵ Adjustable Optics
					PB Pole Bracket
					PB2 Pole Bracket @ 180°
					PSMRB Pole Side Mount Remote Ballast

- 1 Consult Factory For Other Voltages
- 2 FL-220 Only
- 3 FL-320 Only
- 4 Specify Junction Box Mounting, or Surface Conduit Connection
- 5 Consult Factory For Other Options
- 6 Consult Factory For Other Finishes
- 7 Vertical lamp position only +/- 15° or horizontal lamp position only +/- 15°

Example: FL-220-150MH-120-T6-BK-V-NO

Luminaire Dimensions

Luminaire	A		B		C		D		E		F		Weight	
	Inch	mm	Inch	mm	Inch	mm	Inch	mm	Inch	mm	Inch	mm	lbs	kg
FL-220-LSM-V	18.87	479	19.50	495	6.00	152	13 OD	330	9.75	247			23.0	10.4
FL-220-LSM	15.50	393	19.50	495	6.00	152	13 OD	330	9.75	247			21.0	9.5
FL-220-WMS/R	13.75	349	17.50	444	5.00	127	9 OD	228	9.75	247			18.5	8.3
FL-320-LSM	15.50	393	22.50	571	6.00	152	13 OD	330	15.50	393			42.0	19.0
FL-320-LSM-V	29.75	755	22.50	571	6.00	152	13 OD	330	15.50	393			48.5	22.0
FL-320-LSM-CL	18.75	476	22.50	571	6.00	152	13 OD	330	15.50	393			51.0	23.0

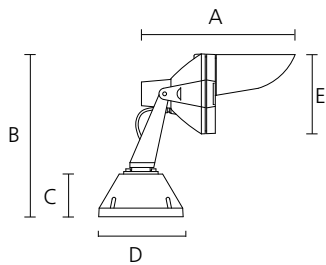

FL-220-LSM-V

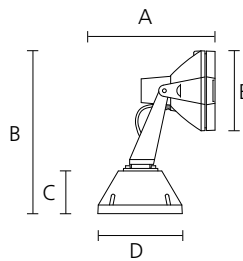

FL-220-LSM

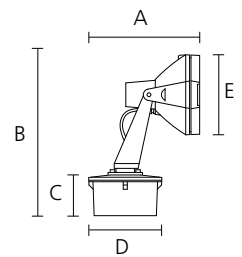

FL-220-WMS/WMR

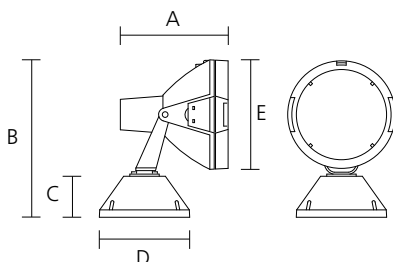

FL-320-LSM

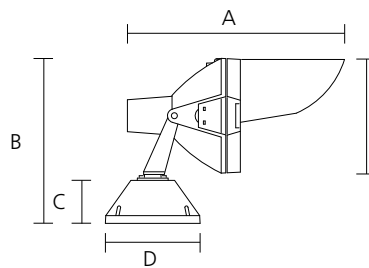

FL-320-LSM-V

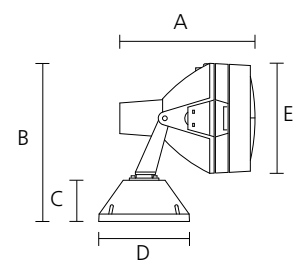

FL-320-LSM-CLV