

Landscape Areas
Wall Wash
Flagpole Lighting
Building Accent
Pedestrian Areas
Driveway Marker
Sign Lighting



Specifications



Certifications ETL and CETL listed for wet location, direct burial, and concrete pour. Certified to IP65 and IP67 to ensure protection against the harshest environments. IEC compliant versions available, consult factory.

Lamp/Ballast Housing Compression molded Rhinolite™ composite material, structurally reinforced with glass fibers. Superior resistance to ultraviolet degradation and corrosion resistant in harsh environments.

Splice Compartment Supplied with two 3/4" NPT conduit entrances. Connection to ballast compartment by way of anti-wicking device. Sealed with gasketed die cast aluminum cover plate. Suitable for through wiring.

Lens Standard 3/8" clear tempered flat borosilicate glass (F) or ADA anti slip and walkover clear tempered flat borosilicate glass (ADA). Flat lenses will withstand loads up to 200 PSI. Sealed to housing with high temperature injection molded silicone gasket. Optional linear spread lens also available.

Lens Frame Heavy duty die cast bronze lens frame is supplied as standard. Fastened to housing with six captive 10-24 stainless steel Allen cap screws.

Reflectors Spun aluminum highly specular Alzak™ finish for either NEMA type 1 or 2 spot (SPT) or NEMA type 3 or 4 flood (FLD) distributions. Field adjustable up to 25° tilt and 360° horizontal rotation. NOTE: Tilt adjustment varies by lamp type. A segmented fluorescent reflector is available for up to 42W lamps.

Lamp Holder Porcelain 4kv pulse rated medium base for HID and Incandescent lamp sources.

Options Cast aluminum Convex Rock Guard (CR), Directional Shield (DS), and Driveway Marker (DM). Consult factory for cast bronze options. Internal Glare Shield (IGS), Internal Hex Cell Louver (HL), Glass Color Filter (GF), Trim Ring (TR), Grout Mask (GM), Debris Cover (DC), Die cast bronze Port Hole (PH).

Finish Housing Black (BK). Options can be painted in standard or custom colors.

Safety Caution: Care should be taken when specifying fixtures for use in pedestrian walkways to avoid problems that may be caused by high lens temperatures. Consult factory for more information.

Warning Caution: Care should be taken not to install in-ground fixtures in areas where water can stand for prolonged periods of time. Sufficient drainage must be provided to avoid problems. Consult factory for more information.

| |
|---------------------|
| PROJECT |
| FIXTURE TYPE |
| CATALOG# |



Some luminaires use fluorescent or high intensity discharge (HID) lamps that contain small amounts of mercury. Such lamps are labeled "Contains Mercury" and/or with the symbol "Hg." Lamps that contain mercury must be disposed of in accordance with local requirements. Information regarding lamp recycling and disposal can be found at www.lamprecycle.org

Product Order Guide

| Series | Max Watts | Lamp Type | Voltage ⁶ | Optics | Options Lens | Finish ^{3,6} | Options |
|--------|---|-----------------------|----------------------|-------------------|--------------|-------------------------------|--|
| SL-23 | Fluorescent | | | | | | |
| | 13CF | CF | 120 | SPT ¹ | Spot | F ¹ Clear Flat | BK ³ Black |
| | 26CFQ | CFQ | 208 | | | ADA ¹ ADA Walkover | BZ ³ Bronze |
| | 42CFT | CFT | 240 | WW ¹ | Wallwash | LS ¹ Linear Spread | WH ³ White |
| | | | 277 | FL ¹ | Fluorescent | | GR ³ Green |
| | High Pressure Sodium | | | | | | |
| | 70HPS | E17 | | NFLD ¹ | Narrow Flood | | NA ³ Natural Alum |
| | | | | MFLD ¹ | Medium Flood | | GY ³ Gray |
| | | | | | | | CC ³ Custom Color |
| | Metal Halide | | | | | | |
| | 70MH | E17 | | | | | GM Grout Mask |
| | 70MH | Par30 ⁸ | | | | | DC Debris Cover |
| | 39MH | Par20 ⁸ | | | | | LFSS ¹ Stainless Steel Lens Frame |
| | | | | | | | STA ¹ Square Top Adaptor ^{5,7} |
| | 70MH | T6 or T4 | | | | | ALOC AIM-LOC |
| | 22MH | BT5 | | | | | AHOT AIM-HOT |
| | 70MH | R111 ⁸ | | | | | ASET AIM-SET |
| | Incandescent/Halogen/Low Voltage | | | | | | |
| | 75INC | Par30 ⁸ | 120 | | | | |
| | 100INC | T4mini | 120 | | | | |
| | 50INC | Par20 ⁸ | 120 | | | | |
| | 75INC | MR16 ⁸ | 120/277/12 | | | | |
| | 50INC | AR111 ⁸ | 120/277/12 | | | | |
| | LED | | | | | | |
| | 1X5 5WLED | CUS ^{8,9,10} | 120 | 10,35,45 | | | White (3050°K/ 4700°K) |
| | Titan 25WW | CUS ⁹ | 120 | 25,35,45 | | | Warm White (3050°K) |
| | Titan 25CW | CUS ⁹ | 120 | 25,35,45 | | | Cool (Daylight) White (4700°K) |
| | Titan 25FIX | CUS ⁹ | 120 | 25,35,45 | | | Fixed Color Red, Green, Blue, Amber |

¹ Not available with the PH Porthole option, use Par20 or MR16 only.

² The DM Driveway Marker can be used with any lamp option.

³ Baked enamel paint standard, powder coat optional.

⁴ The PH Porthole option is supplied as standard in die cast bronze.

⁵ These options are supplied in heavy wall cast aluminum with baked enamel painted finish.

⁶ Consult factory for other voltages and finishes.

⁷ Consult factory for cast bronze options.

⁸ Does not require internal optics.

⁹ The CUS version uses a 5W Atlas from Lamina. The CUS3 uses a 25W Titan from Lamina with no tilt.

¹⁰ AIM-LOC can be used with 1X1WLED, 1X3WLED, 1X5WLED. Consult factory for updates.

CF=single biax, CFQ = double biax, CFT = triple biax

Note: E17 Lamps 175W and below are medium base

Example: SL-23-70MH-T6-277-SPT-F-BK-DS

Luminaire Dimensions

| Luminaire | A | | B | | C | | D | | E | | Weight | |
|-----------|------|-----|------|----|-------|-----|------|-----|------|-----|--------|-----|
| | Inch | mm | Inch | mm | Inch | mm | Inch | mm | Inch | mm | lbs. | kg |
| SL-23-F | 6.95 | 177 | 0.75 | 19 | 14.10 | 358 | 8.50 | 216 | n/a | n/a | 19 | 8.6 |
| SL-23-PH | 6.95 | 177 | 0.75 | 19 | 14.10 | 358 | 8.50 | 216 | 3.35 | 85 | 21 | 9.5 |
| SL-23-DM | 8.00 | 203 | 0.75 | 19 | 14.10 | 358 | 8.50 | 216 | 2.00 | 51 | 21 | 9.5 |
| SL-23-CR | 6.95 | 177 | 0.75 | 19 | 14.10 | 358 | 8.50 | 216 | 1.00 | 25 | 19.5 | 8.8 |
| SL-23-DS | 6.95 | 177 | 0.75 | 19 | 14.10 | 358 | 8.50 | 216 | 3.85 | 98 | 20 | 9.1 |

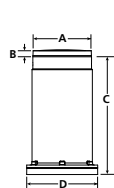

SL-23-F

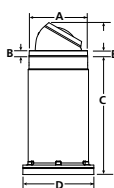

SL-23-PH

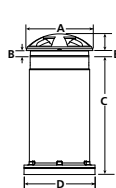

SL-23-DM

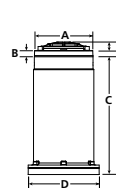

SL-23-CR

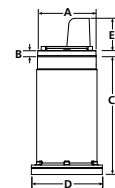

SL-23-DS