

Position 1 1:16 Scale

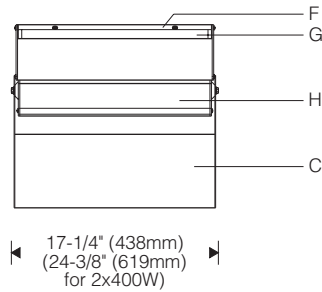

Mounting Plate

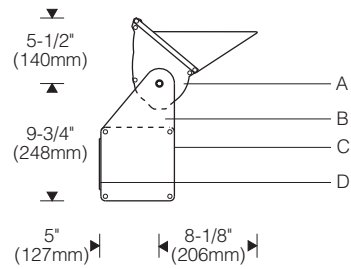
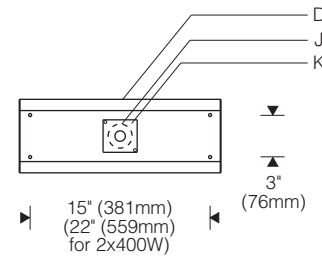

Position 2 1:16 Scale

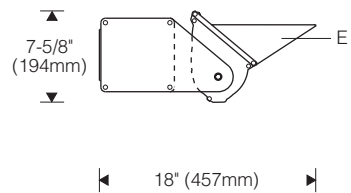

Position 3 1:16 Scale

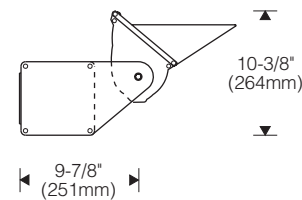

Installation

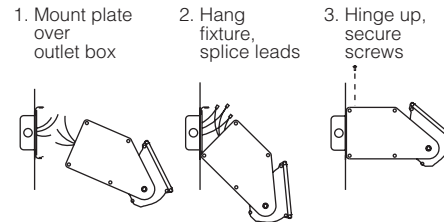

Specifications

- | | | | |
|--|---|---|--|
| A Contoured aluminum end plates | D Extruded aluminum mounting plate | G Micro-prismatic tempered glass lens | J 2" dia. opening to access recessed outlet box (by others) |
| B Aluminum side arms | E Cutoff visor (included) | H Specular extruded aluminum reflector | K Cover plate with 7/8" dia. conduit entry |
| C Extruded aluminum ballast housing | F Overlapping aluminum door frame | | |

Features

- **KO Series** – flexible high performance metal halide uplighting for cost conscious projects; up to 2x400W
- Extruded aluminum reflector, ballast housing – durable and non-corrosive; will not deform during maintenance
- No light leaks – overlapping door; sealed end plates
- Integral CWA ballast for quiet operation



Finish:

Bright clear anodized aluminum housing with semi-gloss black door frame, end plates, side arms, ballast housing and visor or all parts semi-gloss white.

Painted surfaces – 6 stage pretreatment and electrostatically applied thermoset powder coat for stable, long lasting and corrosion resistant finish.

Reflector and internal end plates – extruded high purity aluminum with clear anodized specular finish. All luminaire hardware – stainless steel.

Mounting:

Mounting plate covers recessed outlet box or conduit feed and forms reveal at wall. Suitable backing structure required (by others) – weight up to approx. 60 lb/27 kg (2x400W MH). Fixture hinges on plate for hands-free access to splices.

Uplight pendant mounting assembly ordered separately (see Accessories); specify **X** mount 1-way or **Y** mount 2-way.

Electrical:

Use 90°C wire for supply connections. Mounting plate supplied with one 7/8" diameter entry for direct conduit feed and a 2" (50mm) diameter opening to access splices in recessed outlet box.

Integral constant wattage autotransformer (CWA) or electronic ballast.

Mogul lampholder is pulse rated for use with either horizontal or universal position reduced envelope pulse start lamps. End-of-lamp aligner ensures consistent optical performance.

For complete ballast specifications, see Accessories Section.

Standard:

UL listed or CSA certified for damp locations (Style 408 painted model with gasketed lens recommended for damp locations). 2x400W units suitable for uplight orientation only.

Performance

Two parabolic reflector sections drive light across the ceiling from one edge. An elliptical section shields the lamp from normal viewing angles and redirects its light to a parabola. Glare is minimized and asymmetry of the beam is maximized resulting in high beam efficiency and superior surface uniformity.

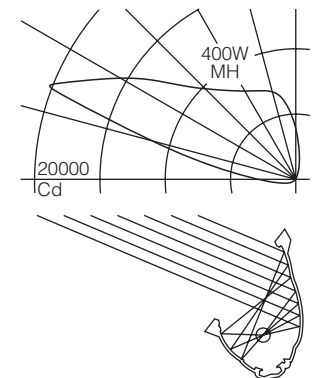

For complete photometrics, visit www.elliptipar.com

To form a Catalog Number

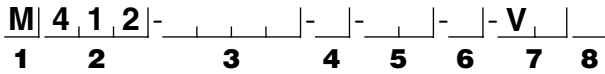

1 Source

M = Metal halide

2 Style

412 = Large KO Series contoured, integral ballast

3 Lamp

| Lamp Code | Watt-age | Lamp Number | Volt-ages |
|--|----------|--------------------------|--------------|
| Ceramic Arc Tube Pulse Start Metal Halide (90+ CRI) | | | |
| 210C | 210 | CDM210/T9/930/U/E | 2, U |
| 315C | 315 | CDM315/T9/930/U/E | 2, U |
| Ceramic Arc Tube Pulse Start Metal Halide (80+ CRI)* | | | |
| 150G | 150 | CDM150/T6/830 | 1, 2 T, U |
| 250C | 250 | CMH250/U/830/R | A, B |
| 400C | 400 | CMH400/U/830/R | A, B |
| 240C | 2x400 | (2) CMH400/U/830/R | A, B |
| Quartz Arc Tube Pulse Start Metal Halide (68 CRI)* | | | |
| 250P | 250 | MS 250W/H75/T15/PS/740 | A, B 2, U |
| 320P | 320 | MS 320W/H75/T15/S/PS/740 | A, B 2, U |
| 350P | 350 | MS 350W/H75/T15/PS/740 | A, B 2, U |

For complete lamp and ballast information, see Accessories Section.
 * Use only clear metal halide horizontal or universal position lamp with compact envelope. Standard lamp colors are 3000K for Ceramic Arc Tube Pulse Start lamps and 4000K for Quartz Arc Tube Pulse Metal Halide lamps.

4 Mounting

Surface: Mounting plate covers conduit feed or recessed outlet box (by others). Choice of three positions:

- 1 = Reflector positioned above ballast housing
- 2 = Reflector positioned in front of ballast housing, side arms sloping downward
- 3 = Reflector positioned in front of ballast housing, side arms sloping upward

Project: _____

Type: _____

Pendant: Reflector is oriented similar to position 2 (in front of ballast housing, side arms sloping downward). Pendant assemblies include appropriate number of luminaires. Order accessory VPN upright pendant separately.

- X = One-way assembly, single uplight
- Y = Two-way assembly, two (2) uplights back-to-back

5 Finish

- 81 = Bright aluminum reflector with semi-gloss black door frame, end plates, side arms, ballast housing and visor
- 02 = Semi-gloss white
- 99 = Custom RAL or computer matched color to be specified, consult sales representative

6 Voltage

- Electronic
- 1 = 120V
- 2 = 277V
- T = 120V dim*
- U = 208-277V dim*
- Magnetic
- A = 120V
- B = 277V

*100-50% dimming, 0-10V compatible controls by others. Consult factory for dimming the 210W lamp.

7 Option (see Accessories Section for specifications)

- VO = Cutoff visor included, no other options
- VR = Halogen standby lamp with integral relay. 100W maximum (lamp included). Not available for 2x400W metal halide.
- 00 = Cutoff visor NOT included, no other options (suggested when enclosure or architectural detail will provide shielding of lens brightness)
- VX = For modification not listed, include detailed description. Consult factory prior to specification.

Note: Cutoff visor included unless specified otherwise.

8 Standard

- 0 = UL, Underwriters Laboratories
- J = CSA, Canadian Standards Association

Example

M412 - 240C - 3 - 02 - B - V00

Large KO Series for use with two 400 watt ceramic arc tube pulse start metal halide lamps. Mounting plate attaches over conduit feed or recessed outlet box (by others). Reflector positioned in front of ballast housing with side arms sloping upward. Semi-gloss white. Two integral 277V ballasts. UL. Cutoff visor included.

Accessories

Order separately. See Accessories Section for specifications.

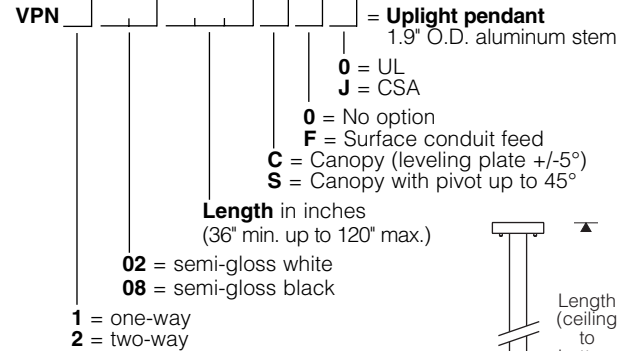

Note: Suitable structure required to support up to 130 lb/60kg. For additional pendant specifications, see www.elliptipar.com.

- AFK000X _____ = Ballast fuse kit
- 0 = UL
- J = CSA

Enclosure Order separately

ELS _____ 000 = Ensconce enclosure
 Specify Style 412 with mounting Position 3 (26" width x 12" height x 22-3/4" depth)

- 02 = semi-gloss white
- 06 = dark bronze*
- 07 = silver*
- 08 = semi-gloss black*
- 12 = green*
- 99 = Custom RAL or computer matched color to be specified, consult sales representative

* Non-white enclosures supplied with white finished interior surfaces. Black finished interior is available – consult factory. APG wire paper guard and ABA Ensconce backsplash shield with black finished interior are available – see Accessories Section and consult factory.

